

# TBX FLANGES

# FLANGE WELDING NECK ASTM A-105

**USO:** En aplicaciones de piping, para conectar extremos de cañerías, accesorios y/o equipos.

**PROPIEDADES:** Adaptabilidad a temperaturas extremas, excelente soldabilidad.

**CLASE:** 150

**DIÁMETROS:** Desde 1/2" hasta 24"

**CARA:** RF (Raised Face)

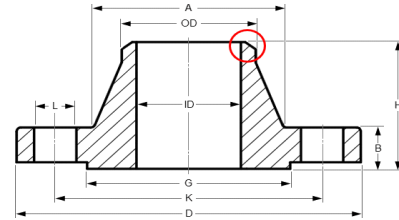

Diámetro nominal	Brida				Cuello		Resalte	Número	Taladros		Peso Aprox. Kg/Und.
	D	ID	B	H	A	OD	G		L	K	
	mm. pulgadas	mm. pulgadas	mm. pulgadas	mm. pulgadas	mm. pulgadas	mm. pulgadas	mm. pulgadas		mm. pulgadas	mm. pulgadas	
1/2"	88.9	15.75	11.1	47.6	30.2	21.3	34.9	4	15.9	60.3	0.5
	3 1/2	0.62	7/16	7/8	1 3/16	0.84	1 3/8		5/8	2 3/8	
3/4"	98.4	20.8	12.7	52.4	38.1	26.7	42.9	4	15.9	69.9	0.7
	3	0.82	1/2	2 1/16	1 1/2	1.05	1 11/16		5/8	2 3/4	
1"	107.9	26.7	14.3	55.6	49.2	33.5	50.8	4	15.9	79.4	1.1
	4 1/4	1.05	9/16	2 3/16	1 15/16	1.32	2		5/8	3 1/8	
1 1/4"	117.5	35.05	15.9	57.1	58.7	42.2	63.5	4	15.9	88.9	1.5
	5 5/8	1.38	5/8	2 1/2	2 5/16	1.66	2 1/2		5/8	3 1/2	
1 1/2"	127	40.9	17.5	61.9	65.1	48.3	73	4	15.9	98.4	1.8
	5	1.61	11/16	2 7/16	2 9/16	1.9	2 7/8		5/8	3 7/8	
2"	152.4	52.6	19.1	63.5	77.8	60.45	92.1	4	19.05	120.6	2.7
	6	2.07	3/4	2 1/2	3 1/16	2.38	3 5/8		3/4	4 3/4	
2 1/2"	177.8	62.7	22.2	69.9	90.5	73.15	104.8	4	19.05	139.7	4.4
	7	2.47	7/8	2 3/4	3 9/16	2.88	4 1/8		3/4	5 1/2	
3"	190.5	78	23.8	69.9	107.9	88.9	127	4	19.05	152.4	5.2
	7 1/2	3.07	15/16	2 3/4	4 1/4	3.5	5		3/4	6	
4"	228.6	102.4	23.8	76.2	134.9	114.3	157.2	8	19.05	190.5	7.5
	9	4.03	15/16	3	5 5/16	4.5	6 3/16		3/4	7 1/2	
5"	254	128.3	23.8	88.9	163.5	141.2	185.7	8	22.2	215.9	9.2
	10	5.05	15/16	3 1/2	6.4375	5.56	7.3125		7/8	8.5	
6"	279.4	154.2	25.4	88.9	192.1	168.4	215.9	8	22.2	241.3	11
	11	6.07	1	3 1/2	7 9/16	6.63	8 1/2		7/8	9 1/2	
8"	342.9	202.7	28.6	101.6	246.1	219.2	269.9	8	22.2	298.4	18.3
	13 1/2	7.98	1 1/8	4	9 11/16	8.63	10 5/8		7/8	11 3/4	
10"	406.4	254.5	30.2	101.6	304.8	273	323.8	12	25.4	361.9	25
	16	10.02	1 3/16	4	12	10 3/4	12 3/4		1	14 1/4	
12"	482.6	304.8	31.8	114.3	365.1	323.8	381	12	25.4	431.8	39
	19	12	1 1/4	4 1/2	14 3/8	12.75	15		1	17	
14"	533		34.9	127	400	355.6	412.7	12	28.6	476.2	51
	21		1 3/8	5	15.75	14	16.25		1 1/8	18.75	
16"	596.9		36.5	127	457.2	406.4	469.9	16	28.6	539.7	60
	23.5		1 4/9	5	18	16	18.5		1 1/8	21.25	
18"	635		39.7	139.7	504.8	457.2	533.4	16	31.7	577.8	71
	25		1 4/7	5 1/2	19.875	18	21		1 1/4	22.75	
20"	698		42.9	144.5	558.8	508	584.2	20	31.7	635	88
	27.5		1 2/3	5 11/16	22	20	23		1 1/4	25	
22"	749.3		46	149.2	609.6	558.8	641.35	20	34.9	692.1	102
	29.5		1 4/5	5 7/8	24	22	25.25		1 3/8	27.25	
24"	812.8		47.6	152.4	663.6	609.6	692.1	20	34.9	749.3	119
	32		1 7/8	6	26 1/8	24	27 1/4		1 3/8	29 1/2	