

TBX FLANGES

FLANGE CIEGO ASTM A-105

USO: En aplicaciones de piping, para conectar extremos de cañerías, accesorios y/o equipos.

PROPIEDADES: Adaptabilidad a temperaturas extremas, excelente soldabilidad.

CLASE: 300

DIAMETROS: Desde 1/2" hasta 24"

CARA: RF (Raised Face)

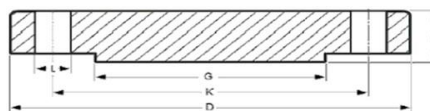

Diámetro nominal	B r i d a		Resalte	Numero	T a l a d r o s		Peso Aprox.
	D	B	G		L	K	Kg/Und.
	mm.	mm.	mm.		mm.	mm.	
1/2"	95.2	14.3	34.9	4	15.9	66.7	0.7
	3 3/4	9/16	1 3/8		5/8	2 5/8	
3/4"	117.5	15.9	42.9	4	19.05	82.5	1.2
	4 5/8	5/8	1 11/16		3/4	3 1/4	
1"	123.8	17.5	50.8	4	19.05	88.9	1.5
	4 7/8	11/16	2		3/4	3 1/2	
1 1/4"	133.35	19.1	63.5	4	19.05	98.4	2
	5 1/4	3/4	2 1/2		3/4	3 7/8	
1 1/2"	155.6	20.6	73	4	22.2	114.3	2.9
	6 1/8	13/16	2 7/8		7/8	4 1/2	
2"	165.1	22.2	92.1	8	19.05	127	3.4
	6 1/2	7/8	3 5/8		3/4	5	
2 1/2"	190.5	25.4	104.8	8	22.2	149.2	5.1
	7 1/2	1	4 1/8		7/8	5 7/8	
3"	209.55	28.6	127	8	22.2	168.3	7
	8 1/4	1 1/8	5		7/8	6 5/8	
4"	254	31.8	157.2	8	22.2	200	11.8
	10	1.25	6 3/16		7/8	7 7/8	
5"	279.4	34.9	185.7	8	22.2	215.95	15.5
	11	1 3/8	7 1/3		7/8	9.25	
6"	317.5	36.5	215.9	12	22.2	269.9	21.3
	12 1/2	1.4375	8 1/2		7/8	10 5/8	
8"	381	41.3	269.9	12	25.4	330.2	35.2
	15	1 5/8	10 5/8		1	13	
10"	444.5	47.6	323.8	16	28.6	387.3	57
	17 1/2	1.875	12 3/4		1 1/8	15 1/4	
12"	520.7	50.8	381	16	31.7	450.8	82
	20 1/2	2	15		1 1/4	17.75	
14"	584.2	54	412.7	20	31.7	514.3	106
	23	2.125	16.25		1 1/4	20 1/4	

16"	647.7	57.2	469.9	20	34.9	571.5	140
	25 1/2	2 1/4	18 1/2		1 3/8	22.5	
18"	711.2	60.3	533.4	24	34.9	628.6	178
	28	2.375	21		1 3/8	24 3/4	
20"	774.7	63.5	584.2	24	34.9	685.8	223
	30 1/2	2 1/2	23		1 3/8	27	
22"	838.2	66.7	641.35	24	41.3	742.9	270
	33	2.625	25.25		1 5/8	29 1/4	
24"	914.4	69.9	692.1	24	41.3	812.8	345
	36	2 3/4	27 1/4		1 5/8	32	